

446 Miriam Two Story \$899,900

Approx. 4100 sq ft
75' x 150' Level Lot at the end of a Private Street

Available Options

- Optional Bonus Room Over Garage (462sf)
- Add a Shower and/or Bath in Powder Room for a Full Bath
- Cabinetry and Countertops for Breakfast Room Desk or Bar Area
- Finished Lower Level

First Floor Plan

2009 Green Tour

Room Dimensions are approximate and may vary slightly. Benchmark Developers & Cachet Homes reserve the right to make changes without notice.

446 Miriam Two Story

Approx. 4100 sq ft

75' x 150' Level Lot at the end of a Private Street

Just a Few of the “Smart” Construction Features You Will Find in this Green Home

- 2 x 6 Walls construction allows for R-19 Insulation
- Caulk & Seal package reduces air infiltration
- Green Guard House Wrap
- 90% Direct Vent Furnace
- Energy Star Rated Marvin Low E Windows
- Energy Star Rated Bosch Appliances
- 18” Soffit provides passive cooling
- Roof Truss Heel enhances attic insulation performance
- R-40 Ceiling Insulation
- Pre-manufactured TJI Floor Joists
- Advantech Engineered wood subfloor
- Direct Vent Sealed Gas Fireplace in Hearth Room
- Low VOC Paints and Caulks
- Sealed Ductwork reduces leakage

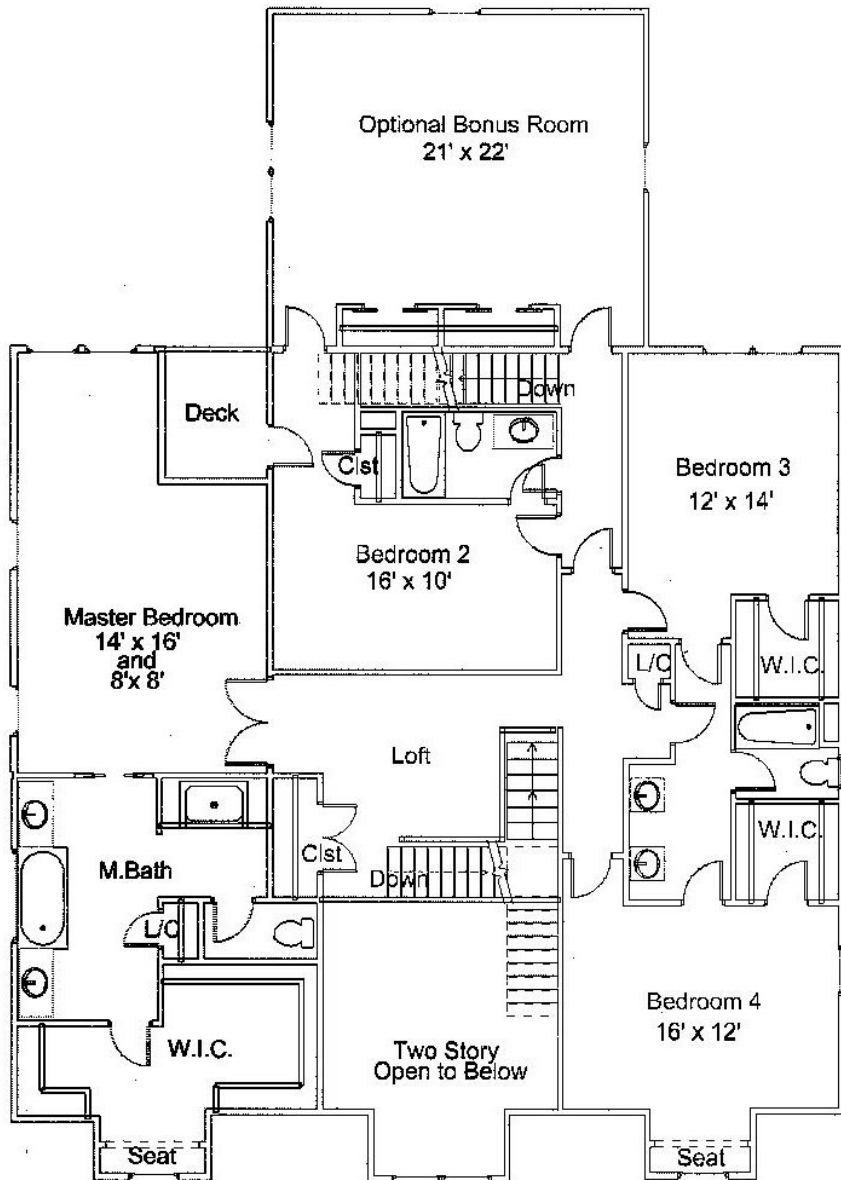

Second Floor Plan

2009 Green Tour

Room Dimensions are approximate and may vary slightly. Benchmark Developers & Cachet Homes reserve the right to make changes without notice.